

# Energy Efficient

AAC offers thermal mass, thermal isolation, whole wall coverage and low air infiltration to provide you with the best possible insulation.



## Real life numbers

These numbers show the actual cooling cost for this Georgia home built with AAC. The monthly highs and lows are shown to illustrate the flywheel effect of AAC insulation.

- Avg. High Temp
- Avg. Low Temp
- Monthly Cost

Temp. ° F

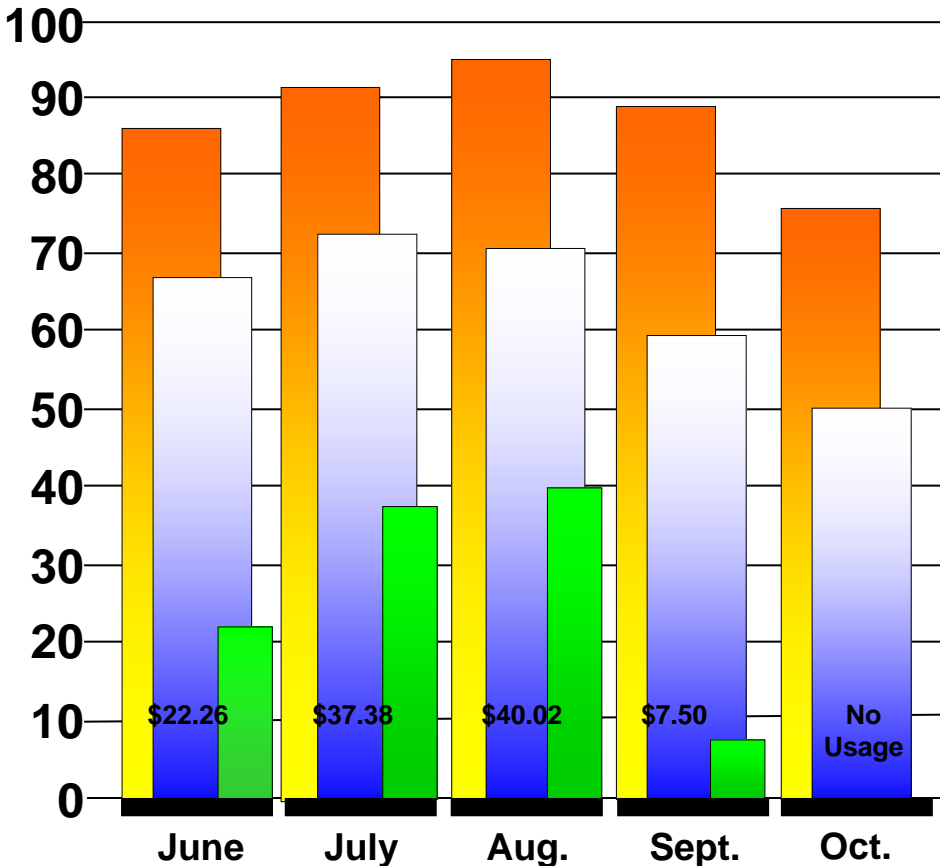

Space monitored: 2400 sqft

Walls: 8" thick autoclaved aerated concrete blocks

Ceilings: insulation R-30  
Average height - 10 feet

Heating/Cooling Unit:  
York Heat Pump 3.5 ton  
SEER rating: 13.5  
HSPF: 8.0

Thermostat setting:  
72° (Summer)

Energy Cost: Based on actual kWh consumption of heating and cooling units metered separately based on .06 cents kWh.

AAC has both high thermal mass and thermal isolation causing it to maintain constant temperatures. In this test a 10" thick AAC wall was painted black with one side facing the sun. The temperature was monitored on the outside and inside of the wall for a 24 hour period to examine the effects of thermal mass inertia. The results were a wide fluctuation of temperatures outside, while the inside remained a comfortable 68° F and only fluctuated by plus or minus 2 ° F.

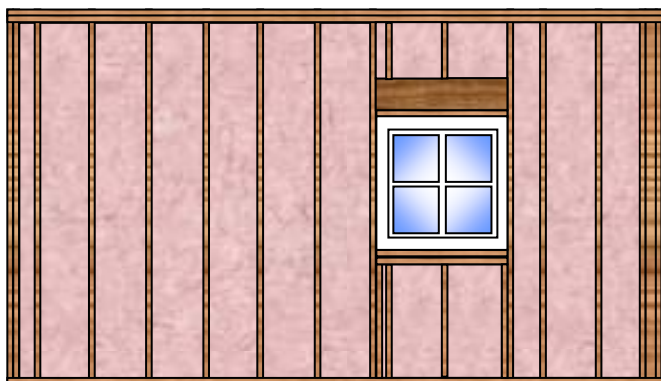
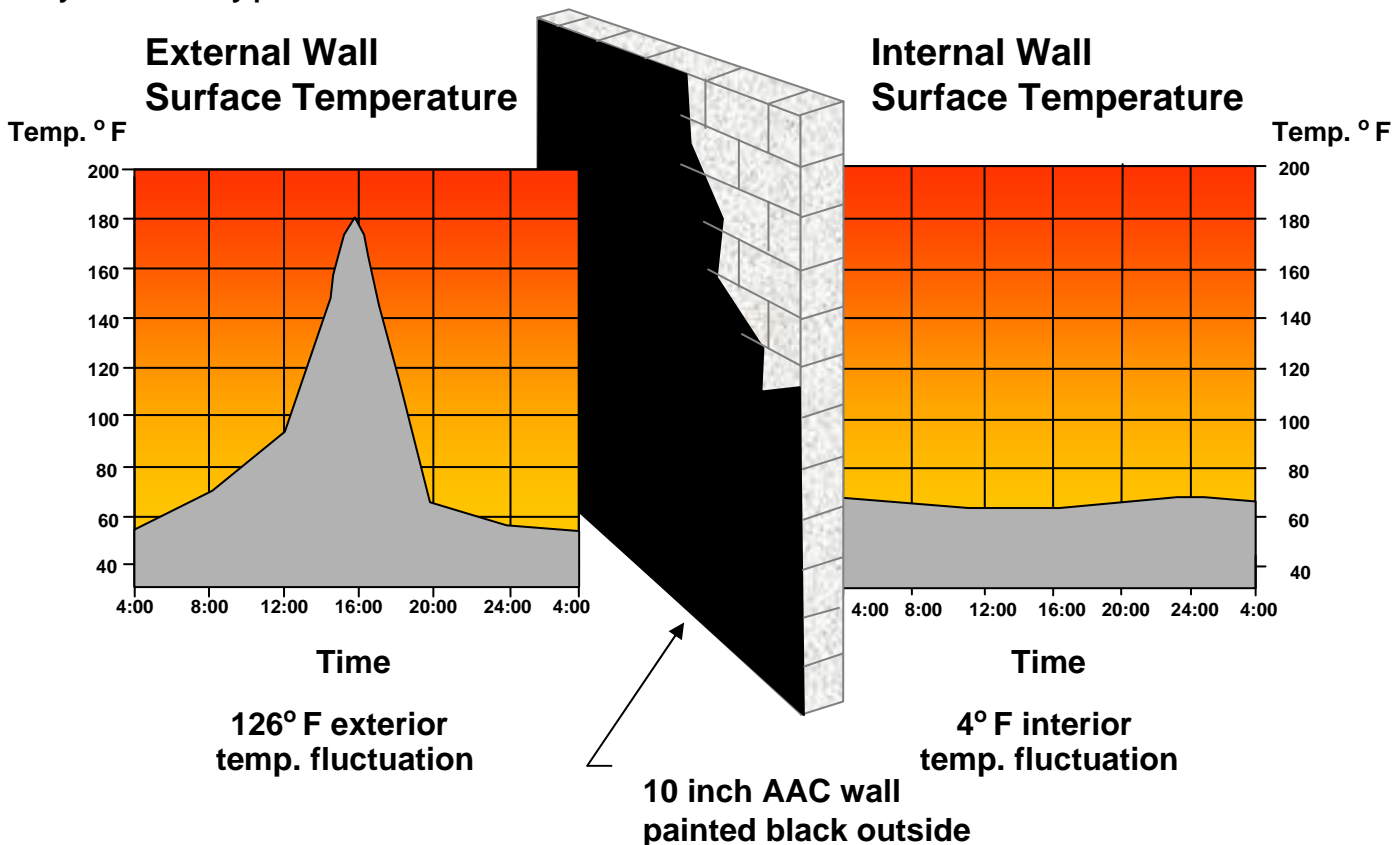

**Stud walls are not fully insulated:**

- No thermal mass
- Air infiltration
- Thermal bridging at every stud
- Deterioration over time

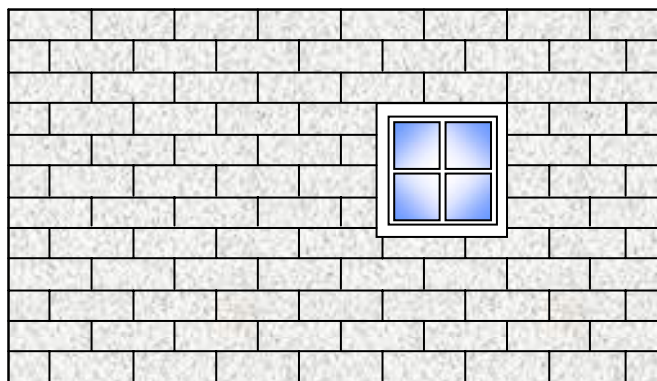

**AAC walls are fully insulated:**

- High thermal mass
- 8-12" of solid insulating material
- Thin joints completely filled
- No deterioration



706-965-4587 phone  
706-965-4597 fax

[www.SafeCrete.com](http://www.SafeCrete.com)

E-mail – [SafeCrete@Babb.com](mailto:SafeCrete@Babb.com)

© 2002-2006 SafeCrete All rights reserved.

6652 Highway 41 North  
Ringgold, GA 30736

